

# Newman Road Woods

A Project for  
Broadland District  
Council



# Project Aims

- **Make any building remains safe:  
Fencing & signage**
- **Ecological Work:**     **Dangerous Tree Felling**  
                                  **Scrub clearance**  
                                  **Hedgerow and tree planting**  
                                  **Bat & Bird Boxes**  
                                  **Ecological Management Plan**
- **Footpath creation and surfacing**
- **Waymarker Posts and Information panel installation**
- **Bench and Parking sign installation**
- **Footpath Leaflet**

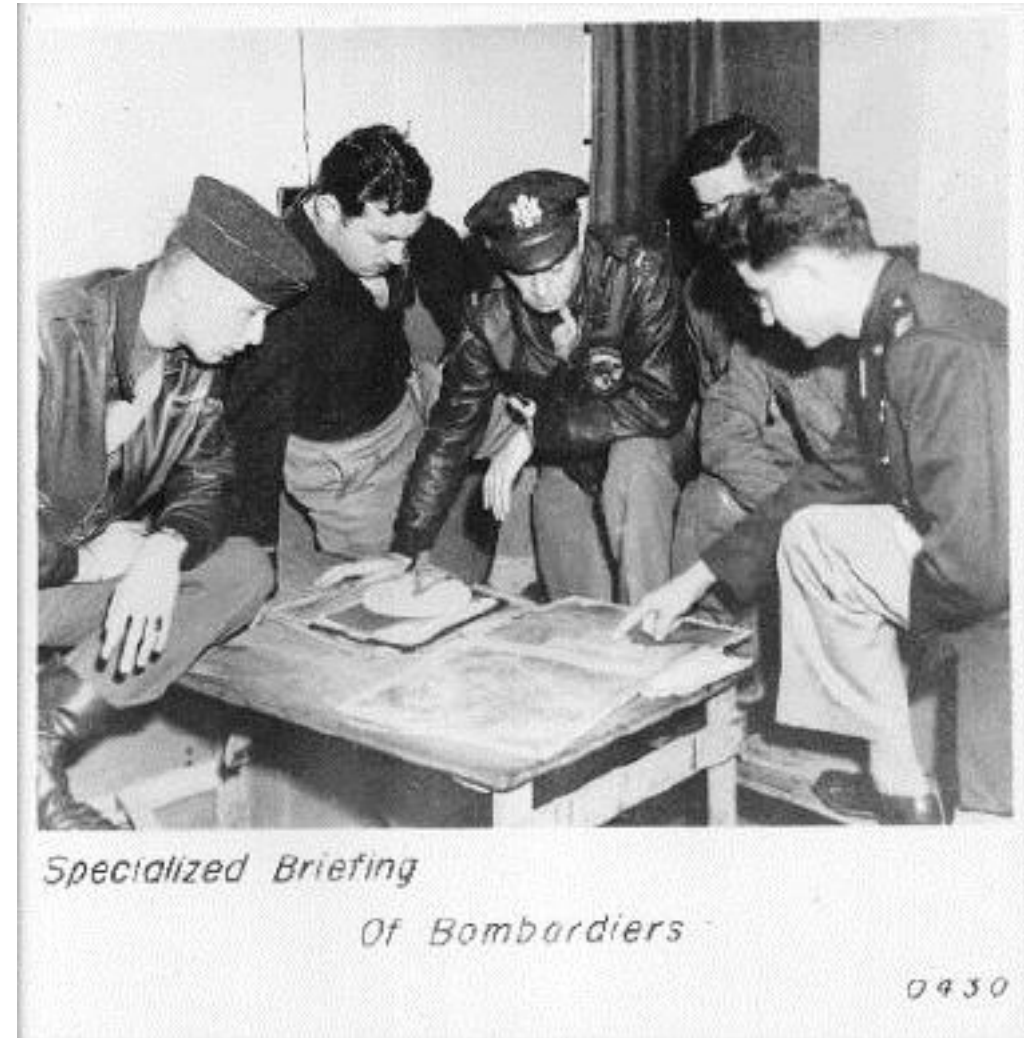

# Where?

## Rackheath Site 6:

### Showers, Dining and Commanding Officers Quarters

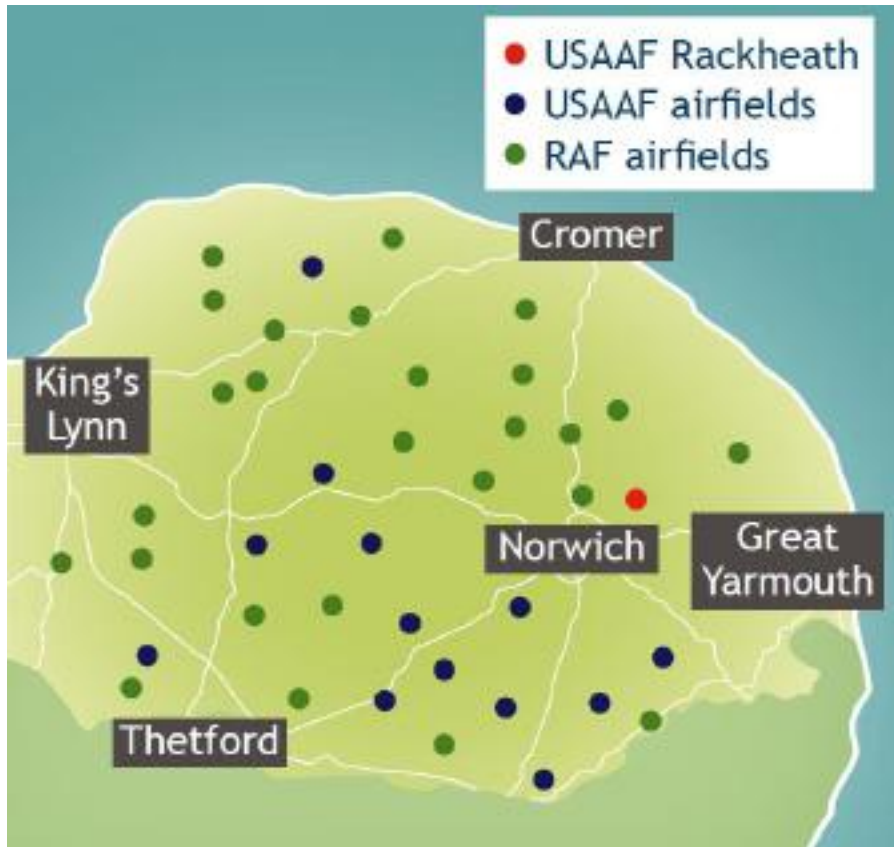

# Who?

## Broadland District Council:

- Annie Sommazzi
- Kay Oglieve-Chan

## Norfolk County Council:

- Danielle Anscombe
- Chris Brough
- Matt Hayward
- Ed Stocker
- Paul Thorogood



## Pathfinders: Rackheath Site 6 Volunteers

(Ivan Barnard, Alec Blyth)

## New Farm Aviation Heritage Group

(Trevor Hewitt, Ken Holmes)

# Who were the USAAF 467<sup>th</sup> Bomb Group – The ‘Rackheath Aggies’ ?



# 467<sup>th</sup> Bomb Group, USAAF

Stationed at RAF Rackheath from  
March 1944 to July 1945

Nicknamed themselves the Rackheath  
Aggies

- Flew B-24 Liberator 'Heavy' bombers
- Best overall accuracy in Eighth Air Force
- 241 personnel lost their lives while at Rackheath
- One of the lowest casualty rates for a bomb group with 46 aircraft lost flying from Rackheath



# Fencing the Commanding Officer's Quarters

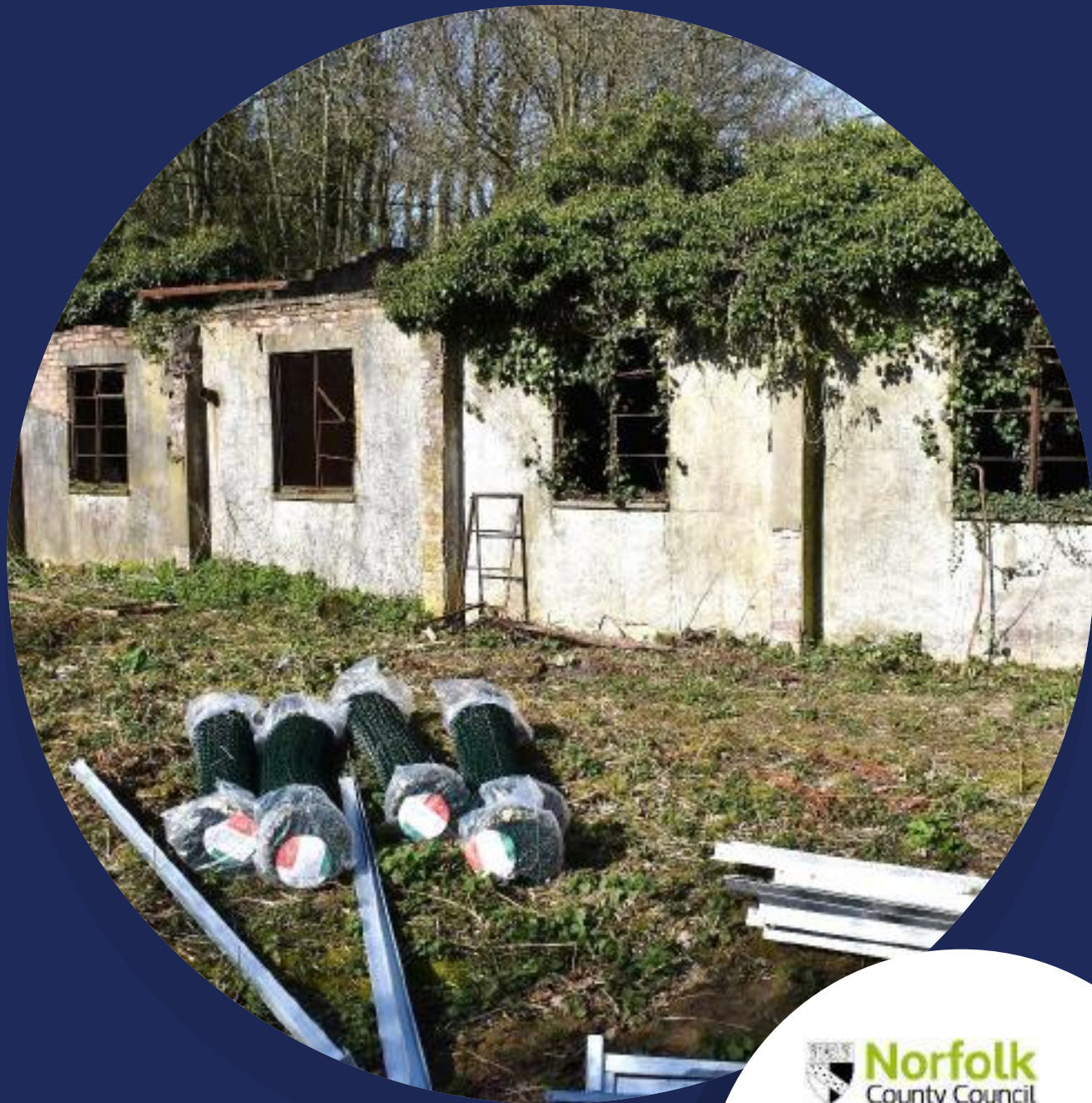

# CO's Quarters

Accommodation and office for 467<sup>th</sup> Bomb Group  
C/O Colonel Albert J. Shower and Lt. Col James  
J. Mahoney from early 1944 – mid 1945

Used as a Scout Hut Post War but now without  
roof, windows or doors and in need of  
preservation and a danger to visitors

Replacing the temporary Heras fence with a more  
secure chain link fence was one of the main  
Project aims







The first step was to clear the area around the hut of vegetation to allow the fencing contractors access



The building began to emerge from the scrub....



# Chain Link Fencing installation by G & G Fencing – March 2020





# Ecological Improvements



Trees and shrubs planted March 2020 by Danielle Anscombe, Ed Stocker, Paul Thorogood and Ivan Barnard

Species	Height (CM)	Price per tree (£) - Blackrow Nurseries	Quantity	Total price	
Field Maple	40-60	£ 0.25	100	£ 25.00	
Hornbeam	40-60	£ 0.60	40	£ 24.00	
Hazel	40-60	£ 0.35	100	£ 35.00	
Hawthorn	40-60	£ 0.35	50	£ 17.50	
Beech	40-60	£ 0.60	20	£ 12.00	
Holly	15-30	£ 1.45	20	£ 29.00	
Privet	60-90	£ 0.80	50	£ 40.00	
Dog Rose	40-60	£ 0.50	40	£ 20.00	
Rowan	40-60	£ 1.70	10	£ 17.00	
Yew	15-30	£ 1.50	10	£ 15.00	
Ionicera Peridy Menum	40-60	£ 1.70	10	£ 17.00	
Guelder Rose	40-60	£ 0.70	10	£ 7.00	
Bamboo canes	90	£ 0.13	460	£ 59.80	
Spiral Tree guards (38mm)	60	£ 0.21	460	£ 96.60	
Crabapple	90-120	£ 1.70	5	£ 8.50	
Apple - Cox	150-180	£ 15.00	1	£ 15.00	
Apple - Bramley	150-180	£ 15.00	1	£ 15.00	
Cherry	150-180	£ 15.00	1	£ 15.00	
Tree shelters	1.2m	£ 1.45	3	£ 4.35	
Tree shelters	0.75m	£ 1.00	5	£ 5.00	
Shelter stakes	0.9	£ 0.40	8	£ 3.20	
				£ 480.95	Total





Field Maple



Hedgerow at the South-Eastern boundary



Western half of the site

# Newman Road Woods Cave Spiders!



A new entry for  
the Newman  
Road Woods  
Biodiversity  
record





# Newman Road Woods: Flora and Fauna





# Tree felling February and October 2020



# Bat Boxes and Bird Boxes



# Ecological Management Plan

## Newman Road Wood, Rackheath.



### Management Recommendations & Action Plan 2020 – 2025

Produced by  
Ed Stocker MCIEM Ecologist, Norfolk County Council

Norfolk County Council



## Welcome to Newman Road Wood, Rackheath.

### Contents:

1. Summary
2. Introduction
3. Habitats
4. Wildlife of Newman Road Wood
5. Access & Amenity
6. Protection & Funding
7. Management of habitats
8. Long term objectives
9. Appendices.

### 3. Habitats:

#### 3.1. Mixed deciduous woodland.



The traditional habitat of Newmans wood has established naturally since the change of land use from military accommodation and military areas.

The woodland contains native trees of oak, ash, hazel, holly, dogwood, alder, field maple and hawthorn.

The shrub layer or 'understorey' is very dense due to the limited light passing through the canopy, and the likely high levels of grazing by numerous deer roe deer.

#### 3.1.1 Standing Deadwood



The woodland contains some dead mature trees, some pre dating the Second World War. They are of great value for biodiversity.

Deadwood in a woodland is very important for bird and bat nesting habitat. It also offers opportunities that become food for birds and bats.

Some plants and fungi also rely on deadwood to thrive.

Where safe to do so, these trees should be snagged and other trees can be selected and felled into standing deadwood for the future.

Snag and bat boxes can also be attached to these trees to increase the wildlife value of the wood.

### 9.1 Action Plan for Newman Road Wood 2020 – 2025

Habitat	Year 1 (2020-2021)	Year 2 (2021-2022)	Year 3 (2022-2023)	Year 4 (2023-2024)	Year 5 (2024-2025)
Woodland	<ul style="list-style-type: none"> <li>Consider applying to become a Local Nature Reserve (LNR) &amp; County Wildlife Site (CWS)</li> <li>Road and Fens Survey</li> <li>Survey perimeter boundaries, fencing/gates.</li> <li>After pick removal of surface rubbish invite Volunteer (Blue Valley Conservation Group) to help with tasks.</li> <li>Clear surface trees and vegetation from the southern side Shelter.</li> <li>Look into funding towards management costs (Countrywide Remembrance)</li> </ul>	<ul style="list-style-type: none"> <li>With updated flora survey and species list, re-apply for CWS status if required.</li> <li>Continue with 2018 Application</li> <li>Continue with funding application to Natural England.</li> <li>Invite Volunteer Blue Valley Conservation Group, History Group for regular holidays.</li> <li>Discuss ideas for the chapel garden.</li> <li>Plant some bulbs in Chapel garden.</li> <li>Monitor paths, matted around benches.</li> <li>Look into laying out hedgerows.</li> </ul>	<ul style="list-style-type: none"> <li>Continue with the habitat management recommendations in the table below.</li> <li>Continue with removal of beds, tools, invertebrate traps, amphibians, reptiles, plants.</li> <li>Monitor the success of any shrubs/understorey that were planted in year 1.</li> <li>Monitor levels of grazing on understorey from Deer, rabbits, roe deer.</li> <li>Two safety inspections</li> </ul>	<ul style="list-style-type: none"> <li>Continue with the habitat management recommendations in the table below.</li> <li>Continue with surveys of birds, bats, mammals, amphibians, reptiles, plants.</li> <li>Monitor the success of any shrubs/understorey that were planted in year 1.</li> <li>Monitor levels of grazing on understorey from Deer, rabbits, roe deer.</li> <li>Tree safety inspections</li> </ul>	<ul style="list-style-type: none"> <li>Review management starting from year 3.</li> <li>Following advice from the management Plan.</li> <li>Keep up to date with new opportunities for funding protection of the site, ways to involve the community.</li> </ul>

And Finally, another addition to the Biological record for Newman Road Wood

- Great Crested Newt found (and put back) by contractors while asbestos was being collected in March 2021.

This has implications for the conduct of future work (no close strimming or disturbance of log piles) and ideas for pond creation



# Waymarking and Information Panels





## Six Information panels on the History and Ecology of Site 6

- Commissioned by Broadland District Council
- Installation Supervised by Norfolk County Council September 2020

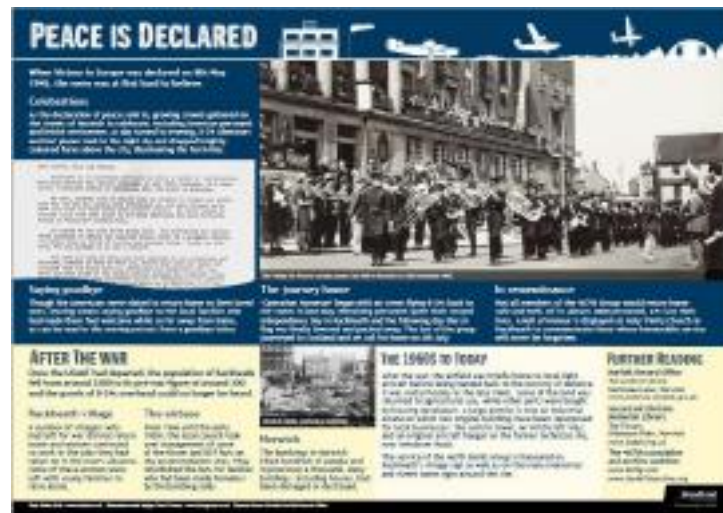





Interpretation Panel installation  
– 29 September 2020

Nine Waymarker posts installed by Martin Plane December 2020

Disk design by Chris Brough and Paul Thorogood, from a design by Fiona Gowen





# The Chapel Garden

Open land next to the Sergeant's Mess. This central plot of land presumably functioned as cycle park for some of the thousands used on the base. Post War use as a Chapel for the Boys Brigade



- Clearance of scrub
- Planting of trees
- Creation of habitat piles
- Privet hedge management

# The Chapel Garden – Cutting Back the scrub and planting in February/March 2020



# The Chapel Garden: Bench Installation



Site signage – Dangerous building and Parking signs  
(with the all important dog waste bin and cycle parking)



# The Future of Site 6





Pathfinders –  
Volunteer group  
of locals and  
Aviation  
Heritage  
enthusiasts

Met most  
Saturdays in  
2020, lockdown  
permitting

Now working  
again since 10  
April 2021



**PATHFINDERS,  
RACKHEATH AGGIES SITE 6  
NEWMAN ROAD WOODS**



# Woodland Footpaths – Concrete and woodchip –June to November 2020



# Clearing the foundations - The Officer's Club





# New Farm Aviation Heritage Group Museum, Frettenham



# NEWMAN ROAD WOODS



# NEWMAN ROAD WOODS AND RACKHEATH USAAF AIRBASE

Newman Road, Rackheath,  
Norfolk NR13 6PN



— Woodland footpath  
□ Information panels

© Crown copyright 2020 OS 100019340



Theatre Trans Lux prepares for a film premiere



The Officers Club, with its 'Sword and Chair' painted sign



Keeping fit on the base

Where you are standing was once Site 6 of RAF Rackheath, USAAF Station 145. The site was composed of an officers' mess, a sergeants' mess, several shower blocks, a large dining hut, a theatre and the Commanding Officer's quarters.

The airbase was completed on 14th February 1944 and later placed in the care of the Royal Air Force (RAF). On 12th April 1944 it was transferred to the 467th Bomb Group (Heavy) in a flag ceremony which involved the lowering of the RAF flag and the raising of the American Stars and Stripes.

### In remembrance

Not all members of the 467th Group would return home safe and well. Of its almost 3000 personnel, 241 lost their lives. A Roll of Honour is displayed at Holy Trinity Church in Rackheath to commemorate those whose honourable service will never be forgotten.



The cosy interior of The Officers Club

### Further Information

[www.the467tharchive.org](http://www.the467tharchive.org)

[www.facebook.com/newfarmaviation](https://www.facebook.com/newfarmaviation)

[www.americanairmuseum.com](http://www.americanairmuseum.com)

Rackheath Parish Council:  
01603 920990  
[clerk@rackheathparishcouncil.org.uk](mailto:clerk@rackheathparishcouncil.org.uk)

Text: Kellie Bell - [www.rackheath.co.uk](http://www.rackheath.co.uk)  
Illustrations and design: Fiona Gowen - [www.fionagowen.co.uk](http://www.fionagowen.co.uk)  
Photos: Norfolk Records Office, 467th Bombardment Group Association, Archives, [www.the467tharchive.org](http://www.the467tharchive.org), [www.467th.org](http://www.467th.org), ©Imperial War Museum (PFE 9363)

**Broadland**  
District Council  
*Community at heart*

The Woodland is to be passed onto Rackheath Parish Council for local management

 **Norfolk**  
County Council

# POOP from Group



Newsletter of the 467th Bomb Group Association

June 2020

## Site #6 Work commences!



## Walking in the Footsteps of Legends.

*We peel back a Carpet of Undergrowth to reveal the Hidden Heritage of Site 6*

This is the sixth consecutive article that I have been privileged to write and report to you, on the progress of the project. The previous five have all been about ideas, concepts, and plans and to some extent even dreams, although not necessarily in that order. This time it's about living the dream, turning all those words into reality and so in late February 2020 we commence work on site. The initial team on site consisted of Paul Thorogood, Edward Stocker and Danielle Anson of Norfolk County Council. Ivan Barnard and Ken Holmes of NFAHG. Chris and Jamie of Eastern Countryside Services.

The first job was for the tree surgeons to cut down the dangerous and inappropriate trees, in order to have a safe and managed mixed woodland for the Rackheath community to enjoy and appreciate. This was followed by scrub clearance, building of habitat piles, ivy roots cut through at ground level both inside and outside of the "White House" to prevent further damage to the building, clearing of dense undergrowth and fallen trees to the side and behind the "White House."



Part of the tree management work. L to R: Edward Stocker NCC Ecologist, Chris Day, Tree Surgeon, Ivan Barnard Heritage Volunteer, Zomic, Tree Surgeon.



Ken & Jamie working on the path.

Ken Holmes and myself entered the temporary enclosure around the "White House". Here working from original Air Ministry record drawings we pushed and prodded until we found the concrete path, on which both Col A. J. Shorro and Lt

Transatlantic Interest – the 467<sup>th</sup> Bomb Group (H). The Rackheath Aggies

## Return to Norwich 2020 May 5 - 9



After 10 years we make a most welcome return to the historic Maids Head Hotel, Norwich, and opportunity to visit the former Bases of both Rackheath and North Pickenham in an exciting program you will not want to miss. This all takes place over the 75th anniversary of VE-Day with commemorations centered on many of these significant places the United States Army Air Force made a lasting impression in the city of Norwich and in the villages beyond. See you all in MAY!

### RESERVATION DETAILS, MAIDS HEAD HOTEL:

**Tuesday 5 May to Friday 8 May, 2020.**

Classic Doubles @ £120.00

Executive Double Rooms also includes Twin Rooms @ £140.00

Single Rooms @ £100.00

Rates are per room per night and include full English breakfast and VAT @ 20%

These rates to apply for any additional nights requested by guests to stay, however, there will be a £30.00 per room supplement for staying on a Saturday night.

<https://www.maidsheadhotel.co.uk/bedrooms> for room details and facilities at this traditional and historic 4 star hotel.

Reservations to be made by email to [reservations@maidsheadhotel.co.uk](mailto:reservations@maidsheadhotel.co.uk) and in the Subject line state "467th Bomb Group Assoc. Event" and clearly register the dates and number of nights, type of room, for reservation. Alternatively, reservations can be made by telephone to Melissa Thomas (Reservations Supervisor) Monday-Friday directly to the Maids Head, 011-44-1603-272007. Ensure reservations are made before 1st April to avoid disappointment. Why not extend your stay and maximise enjoyment of the vibrant, historic city of Norwich and its host of attractions.

<https://www.visitnorfolk.co.uk/explore/Norwich.aspx>

*Continued next page*



# The End of the Project?

(Only for Norfolk County Council!)



Nathan Halkhoff, George Mills, Theologos Missiras, ?, John Stewart (insi



There are several proposals for the Museum and local volunteers to develop the site in conjunction with Rackheath Parish Council

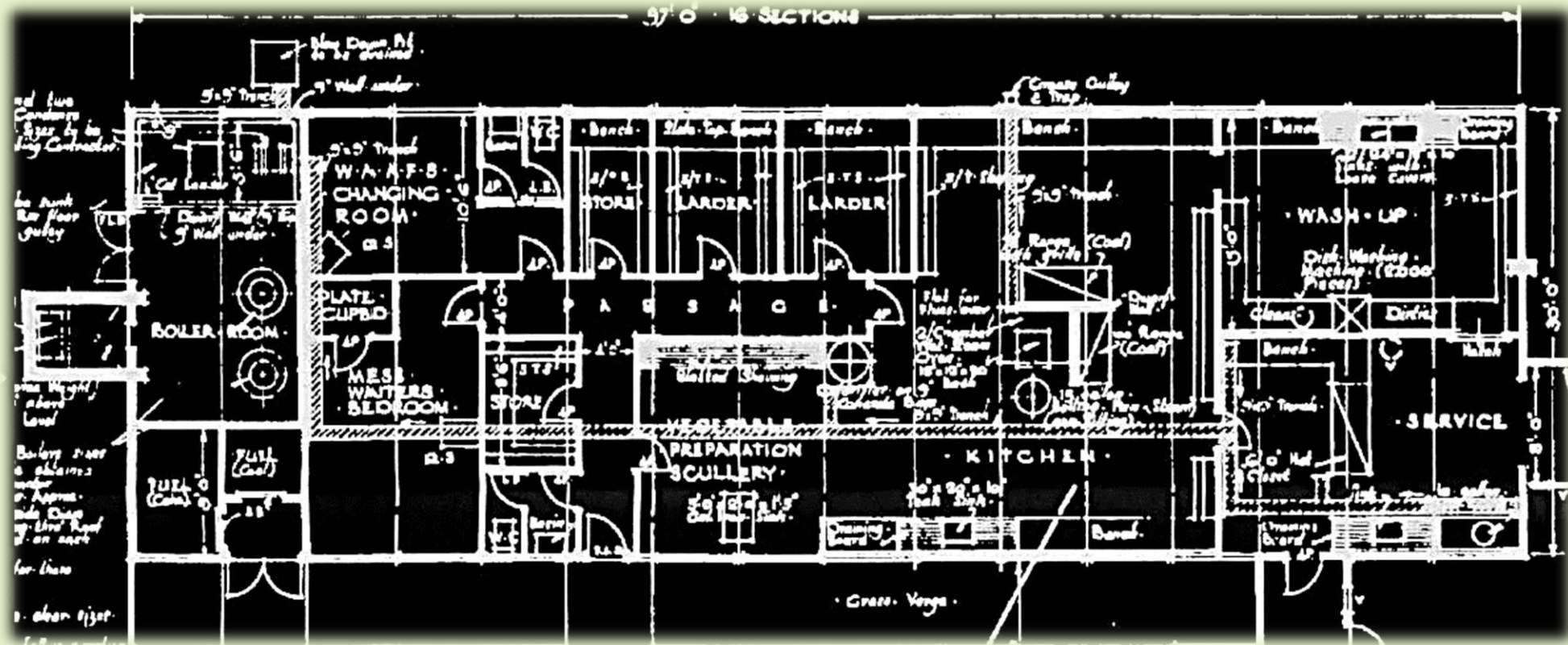

Such as:

- A Ground Museum, with building functions stenciled onto foundations
- A downloadable Audio-visual Trail, providing images and commentary on life at RAF Rackheath during wartime



Thank  
you for  
your  
attention



467<sup>TH</sup>  
BOMBARDMENT GROUP HEAVY  
2<sup>ND</sup> AIR DIVISION 8<sup>TH</sup> AIR FORCE  
UNITED STATES ARMY AIR FORCE  
UNDER THE COMMAND OF  
COLONEL ALBERT J. SHOWER  
FLEW 212 COMBAT MISSIONS  
5538 AIRCRAFT SORTIES  
WITH LOSSES OF 235 AIRMEN 46 AIRCRAFT  
IN B24 LIBERATOR BOMBERS FROM THIS AIRFIELD  
FROM MARCH 11<sup>TH</sup> 1944 TO JULY 5<sup>TH</sup> 1945  
OVER 5000 AMERICAN AIRMEN STATIONED HERE  
MADE A MAJOR CONTRIBUTION TO THE DEFEAT OF  
NAZI GERMANY IN WORLD WAR II

DEDICATED JULY 29<sup>TH</sup> 1990  
THE FOUR HUNDRED AND SIXTY SEVENTH  
BOMBARDMENT GROUP HEAVY ASSOCIATION LTD